

COPYRIGHT:  
The design and details shown on this drawing are applicable to their project only and may not be reproduced in whole or in part or be used for any other project or purpose without the written permission of TOT Architects with whom copyright resides.

DO NOT SCALE from this drawing. Use figured dimensions.  
Contractor to check all dimensions on site prior to commencement of works. Any discrepancies are to be referred to the ARCHITECT.

KEY PLAN:  

1 PROPOSED GROUND FLOOR PLAN  
PA-200 Scale: 1:200 @A1

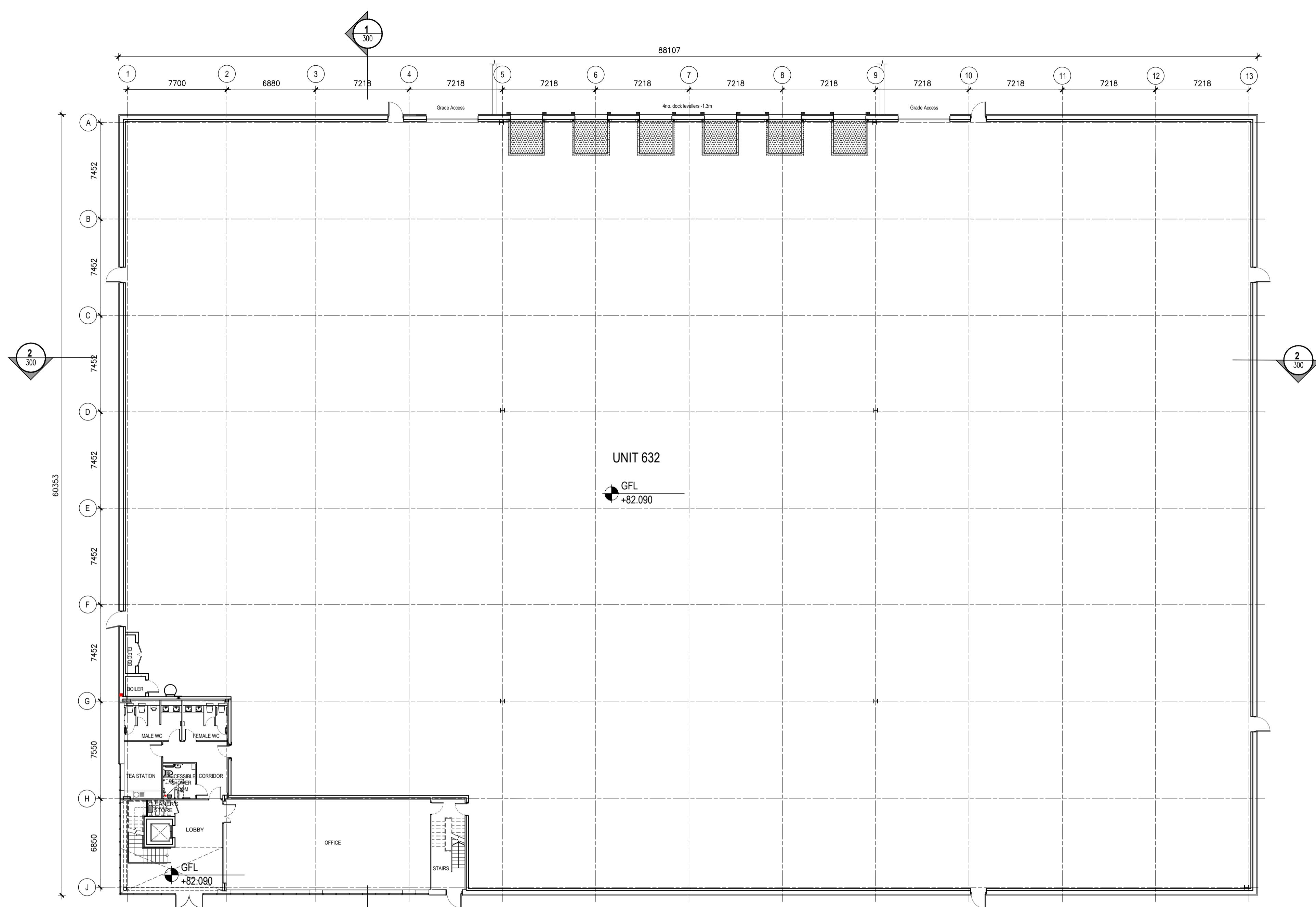

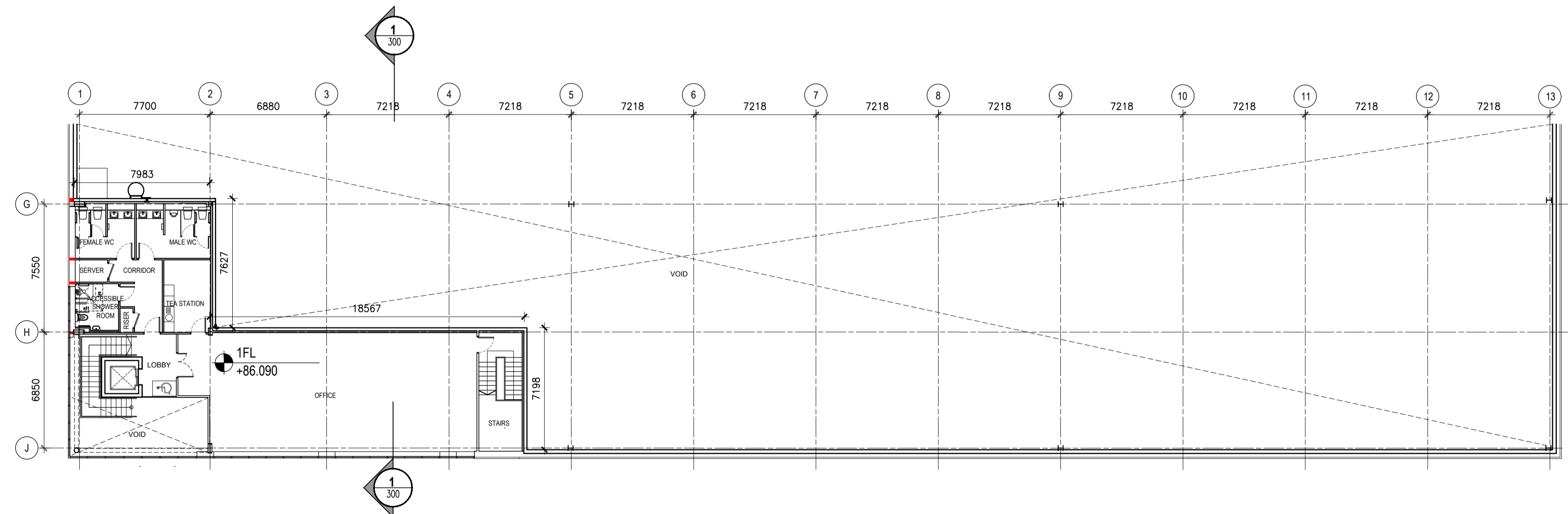
2 PROPOSED FIRST FLOOR PLAN  
PA-200 Scale: 1:200 @A1

Gross Internal Area Schedule:

Office GFL -	193m <sup>2</sup>
Office 1FL -	228m <sup>2</sup>
Total Office -	421m <sup>2</sup>
Warehouse -	4979m <sup>2</sup>
Total GIA =	5400m <sup>2</sup>

REVISIONS

NO.	DATE	REV.	BY	CHECKED	DESCRIPTION

DATE	REV.	BY	CHECKED	DESCRIPTION
22.07.2019		IK	NW	ISSUED FOR PLANNING



49 Upper Mount Street  
Dublin 2, Ireland. T + 353 1 703 7800  
W www.totarch.ie F + 353 866005670 I info@totarch.ie

PROJECT: Hantise Ltd.  
Warehouse/Logistics/Light Industrial Unit  
Northwest Business Park

STAGE: PLANNING

DRAWING TITLE: FLOOR PLANS  
PROPOSED UNIT 632

DATE:	JULY 2019	DRAWING NO:	PA-200
SCALE:	1:200 @ A1	CHECKED:	NW
DRAWN:	IK	SHEET SIZE:	REVISION:
CHECKED:	NW	JOB NO:	19-37
JOB NO:	19-37	FILE NAME:	19-37 - PA-200
			A1 *